

# ANGAMA MARA



## *Fact Sheet*

*'While nothing can quite prepare oneself for the first time one sees that view, the Angama Mara team are joyful in being of service, with a spirit of generosity to ensure that guests feel cared for.'*

Steve Mitchell, Co-Founder



ANGAMA.COM

## ALL YOU NEED TO KNOW:

- The views stretch for miles. Perched upon the Olololo Escarpment 1,000ft above the plains of the Mara below, the name of the lodge was inspired by the Swahili word for 'suspended in mid-air' and no matter where in the lodge you are, you are guaranteed the best seat in the house
- Access is easy with a short 45-minute scheduled flight from Nairobi's Wilson Airport to the Mara
- The lodge is divided into two identical but completely separate camps, each with 15 Tented Suites
- The Tented Suites span over 100sqm, including the deck, and feature 11m wide floor-to-ceiling glass frontage offering views from everywhere
- Many of the loveliest scenes from *Out of Africa* were filmed on the site of Angama Mara. As a nod to the film, the lodge offers intimate picnics for two on the crest of the Out of Africa kopje featured on the movie's poster complete with sparkling wine on ice and elegant picnic food
- Angama Mara's Photographic Studio is a workplace of creativity with photographers on hand to provide tutorials, editing sessions, photoshoots and equipment hire
- The Shamba is a one-acre vegetable garden where guests can pick their own lunch to enjoy under the towering, shady Moth trees
- From its Guides through to its Camp Manager, the majority of Angama Mara's staff are Maasai from local communities. This means that guests can learn more about local culture from those around them, as well as from the Maasai ladies in the Beading Studio

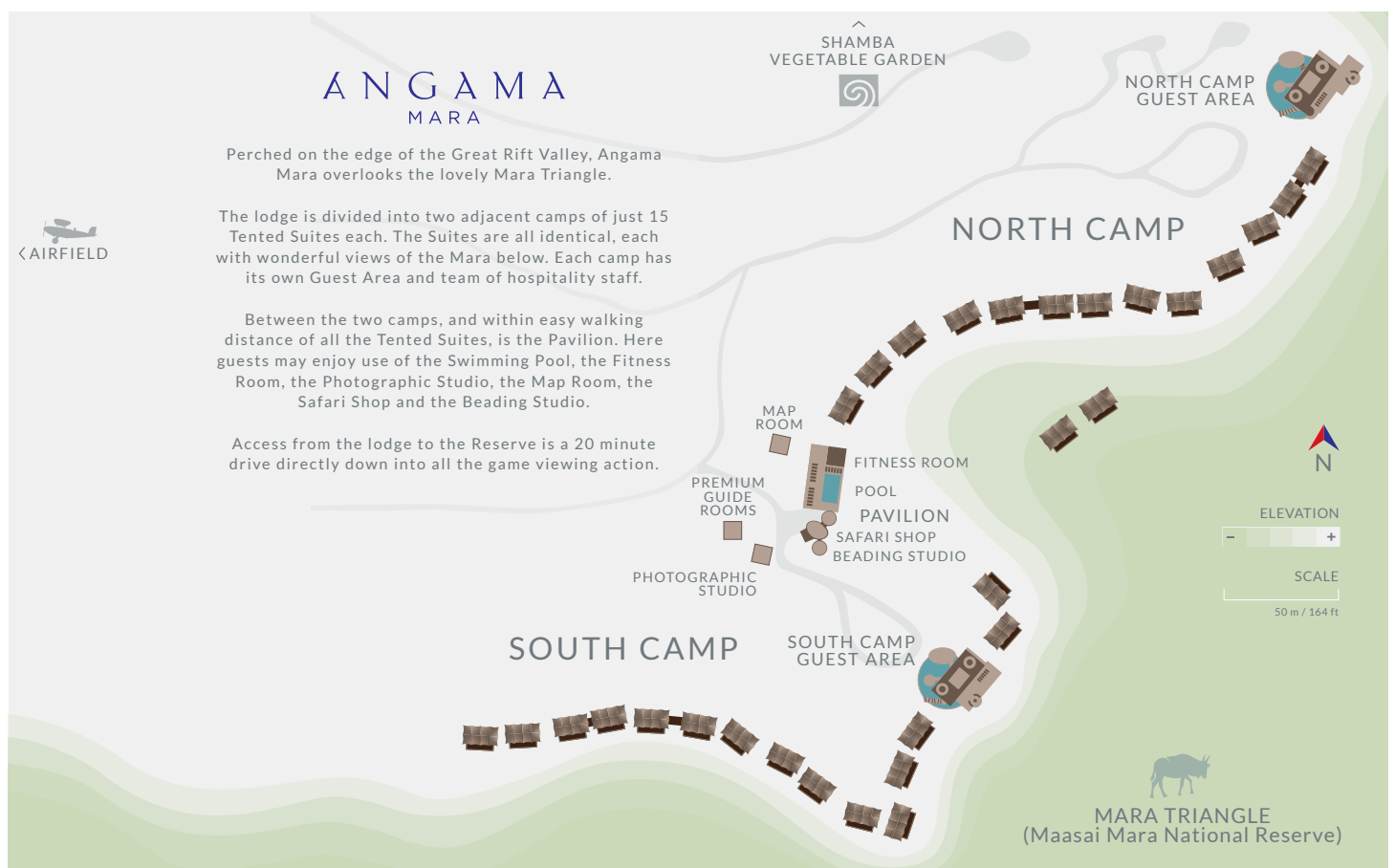

## HOW TO GET HERE:

Angama Mara is easily accessed by plane from Nairobi's Wilson Airport, with several daily flights that land in the Mara, where an Angama Mara Guide will be waiting to transfer you to the lodge, which is just a short game drive away.

Another popular route is to connect via the Serengeti and cross the Tanzania/Kenya border west of the Mara. From the Serengeti, it's a short hop to Tarime, a quick road transfer across the border to the Migori airstrip in Kenya, and another short hop into the Mara.

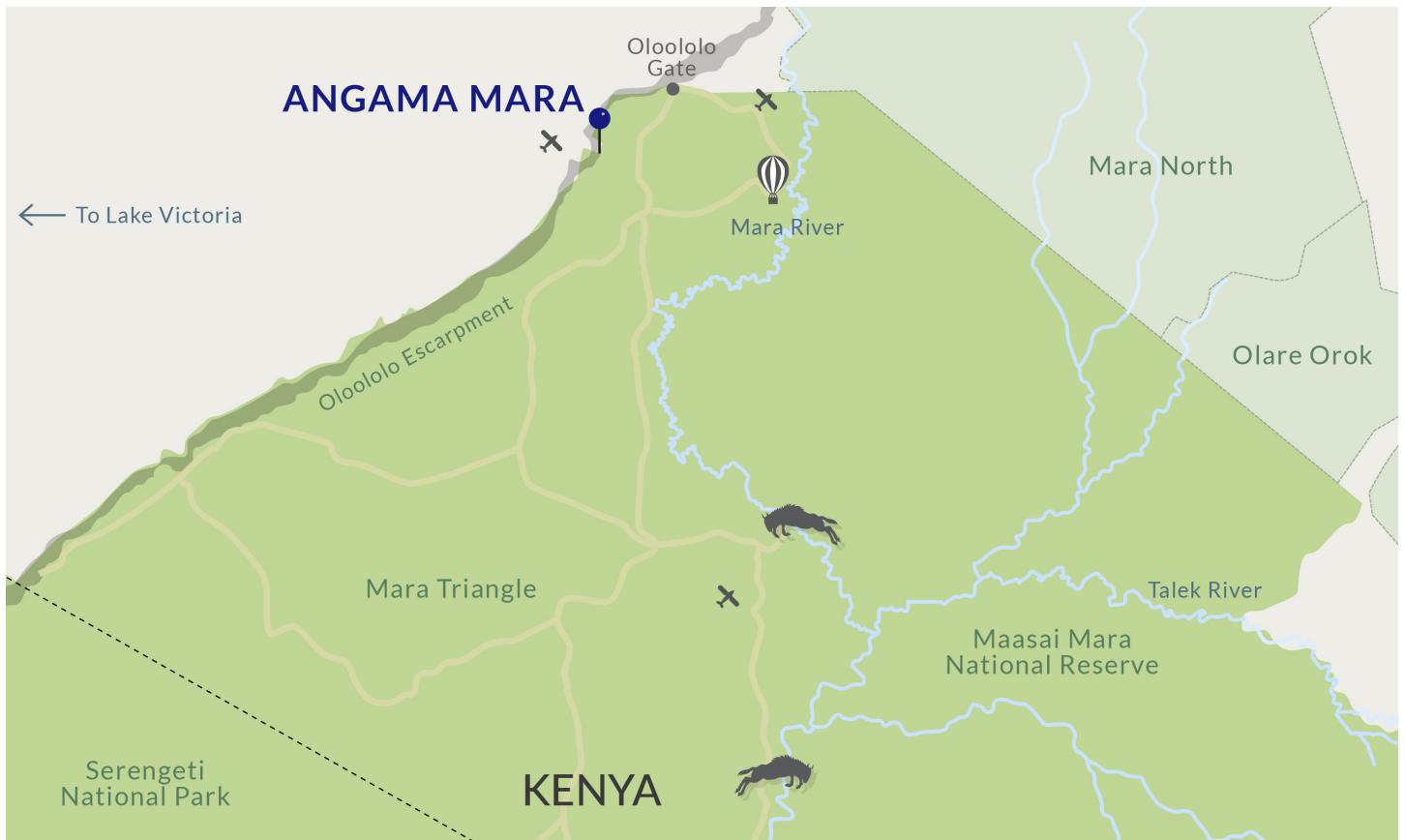

## LODGE INFORMATION

<b>Number of Tented Suites:</b>	2 camps of 15 Tented Suites each
<b>Maximum Number of Guests:</b>	30 guests in each Camp
<b>Interconnected Family Suites:</b>	2 sets of 2 interconnected family suites in each Camp
<b>Children:</b>	Children of all ages are welcome year round
<b>Childminding:</b>	Yes – female staff

## LODGE INFORMATION

<b>Security:</b>	24-hour The lodge is unfenced and guests are not permitted to walk unattended around the Camp after sunset
<b>Check In:</b>	12h00
<b>Check Out:</b>	10h00 Changeroom available for guests with late departures Early check-in and late check-out subject to availability
<b>Swimming Pool:</b>	Yes
<b>Electricity:</b>	24V DC
<b>Kosher Facilities:</b>	Yes – stand-alone kitchen
<b>Plug Points:</b>	Yes – multiple international, 240v
<b>Mobile Network:</b>	Yes – several service providers
<b>WiFi:</b>	Yes – widespread coverage
<b>Private Dining:</b>	Yes
<b>Outdoor Dining:</b>	Yes
<b>Credit Cards:</b>	Yes – Visa, Mastercard and American Express
<b>In-Suite Massage:</b>	Yes
<b>Fitness Room:</b>	Yes
<b>Library:</b>	Yes – in each Camp, equipped with TV and Africana Book and DVD collections
<b>Safari Shop:</b>	Yes
<b>Photographic Equipment:</b>	Yes – available for hire from the Photographic Studio

# ANGAMA MARA

TENTED SUITE

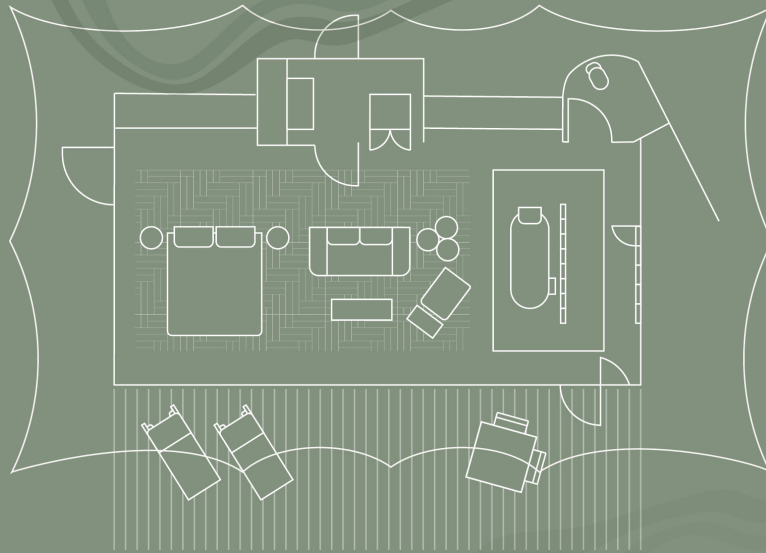

# ANGAMA MARA

INTERCONNECTED SUITES

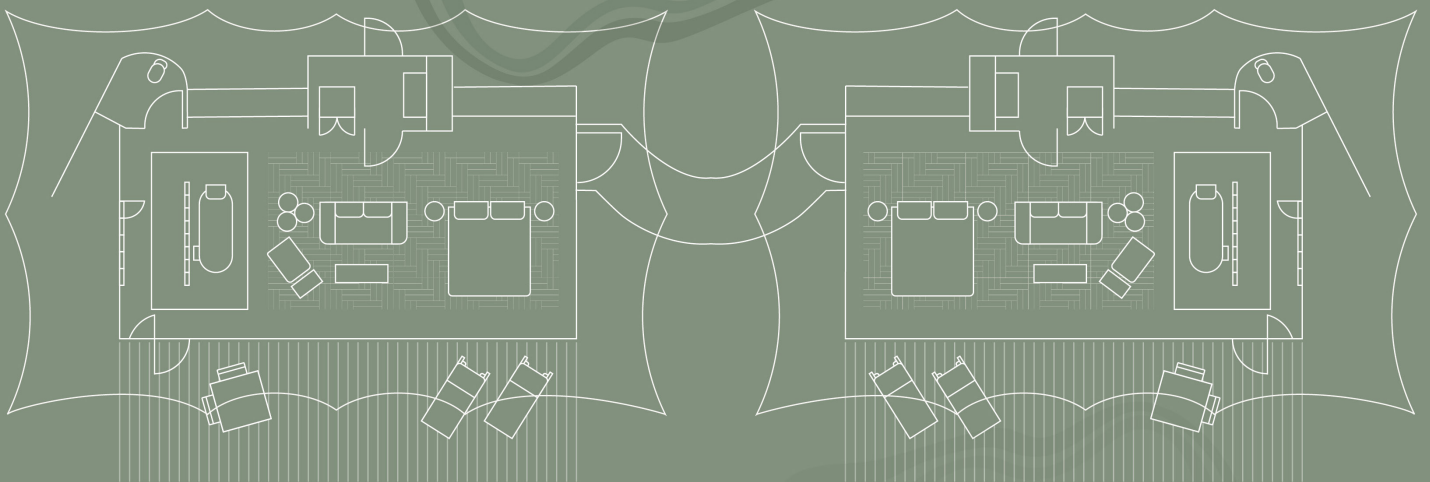

## TENTED SUITE INFORMATION

Bed Size:	Super king, extra length All Suites can be configured with twin bed set-up
Fans:	Yes
Air conditioning:	No
Mosquito Nets:	No – unnecessary due to sealed tents and lodge at high altitude
Bath:	Yes
Shower:	Yes
Twin Vanities:	Yes
Separate W/C:	Yes
Personal Bar:	Yes – complimentary
Safe:	Yes
Telephone:	Mobile phone
Emergency Siren:	Yes
Hairdryer:	Yes
Disabled Access:	Yes – one Tented Suite fully wheelchair-enabled
Laundry:	Yes – complimentary
Binoculars:	Yes
Butler's Lobby:	Yes
In-Suite Tea and Coffee:	Yes
Size of Tented Suite:	70 sqm (750sqft)
Size of Deck:	35 sqm (375sqft)



## ACTIVITIES

Private Vehicle:	Yes – available on request at an additional charge
Morning Safaris:	Yes
Afternoon Safaris:	Yes
All-day Safaris:	Yes
Night Safaris:	Yes – limited
Walking Safaris:	Yes – on the escarpment
Community Visit:	Yes – available on request at an additional charge
Hot-air Ballooning:	Yes – available on request at an additional charge

## TRAVEL INFORMATION

Climate:	Warm and temperate all year round
Altitude:	1,700m (5,580ft) above sea level
Rainfall:	Long rains: March – May Short rains: November – December Please note: rain generally occurs in brief afternoon thunder showers
Temperature:	Summer temperatures: min 20°C/68°F and max 34°C/94°F Summer: October – April Winter temperatures: min 11°C/52°F and max 25°C/77°C Winter: May - September
GPS Co-ordinates:	1°16' 33.38" S, 34° 58' 9.34 E
Malaria Protection:	Low risk – seek medical advice prior to travel
Yellow Fever:	Many countries require travellers to have a Yellow Fever certificate prior to returning from a visit to Kenya
Currency:	USD, GBP, EUR & Kenyan Shillings
Travel Requirements:	All foreign visitors, including infants and children, who travel to Kenya are required to have an approved Electronic Travel Authorization (eTA) before the start of their journey. The processing fee of USD \$30 is applicable for many nationalities, including the US and UK, payable online at the time of application through the online portal. Please make sure your passport is valid for a minimum of six months after arrival in Kenya, with a minimum of three consecutive blank pages

## CONTACT

Reservations	<a href="mailto:enquiry@angama.com">enquiry@angama.com</a>
Travel Partners	<a href="mailto:rates@angama.com">rates@angama.com</a>



[ANGAMA.COM](http://ANGAMA.COM)