



# ANGAMA

## SAFARI CAMP

### *Fact Sheet*

*"Our purpose is to provide an impeccable safari experience that distils the sophistication of simplicity right down to its very essence. Stare at the fire, listen to the birds, read, take a nap, relax in the red rocker, watch the sun set, cook over the coals; breathe the fresh air, try and count the stars, and share many stories. Our wish is for our guests to experience an overwhelming sense of 'this is all mine'."*

Nicky Fitzgerald, Owner of Angama Mara



ANGAMA.COM

## WHAT SETS ANGAMA SAFARI CAMP APART:

- An intimate sole-use light-footprint movable camp set in the Mara surrounded by the astounding year-round wildlife
  - Set in the heart of the mega herds during the months of the annual Migration
  - Pitched on private camp sites deep in the remote wilderness areas of the Mara
  - Each day's programme is entirely up to the guests with a dedicated Safari Camp team, guide and vehicle
  - A fresh, uncluttered approach to safari camp design maximising the light and views thanks to the tents' landscape orientation
  - A four-layer tented roof system designed for maximum cross ventilation
  - Interiors that echo the fresh approach to design of Angama Mara with the best of everything but always just the right amount of everything
  - When in the Mara Triangle easy access to Angama Mara offering guests the best of both: days spent poolside at the lodge, access to the Photographic Studio, Fitness Centre, Beading Studio, Safari Shop, and much loved Shamba, and starlit nights back at Angama Safari Camp
- 

## ANGAMA SAFARI CAMP:

- Opened September 2020
  - Exclusive-use camp accommodating up to 8 guests in 4 ensuite tents
  - Light-footprint tented camp located in the Mara all year round
  - Pitched on exclusive-use wilderness campsites within the Mara
- 

## LOCATION & ACCESS:

- Daily scheduled flights from Nairobi's Wilson Airport to the closest airstrip to Angama Safari Camp's location
- 45-minute flight, depending on routing
- On average a 60-minute safari from the airfield to camp, depending on game viewing enroute
- Excellent air access from Nairobi and the Serengeti (via Migori in Kenya and Tarime in Tanzania)
- Accessible by road from other camps in the Greater Maasai Mara



# ANGAMA

SAFARI CAMP

ANGAMA SAFARI CAMP TENT

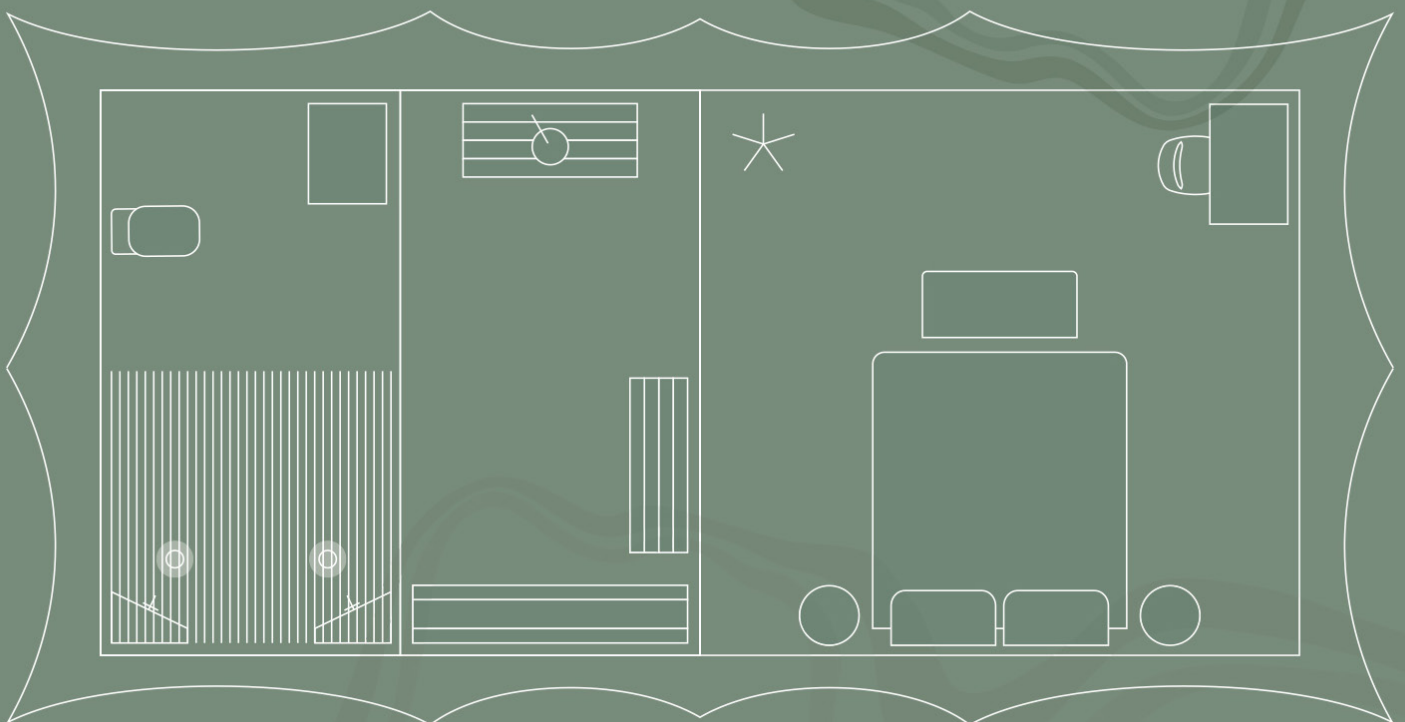

## CAMP INFORMATION

|                              |   |
|------------------------------|---|
| Number of Guest Tents:       | 4 tents   |
| Maximum Number of Guests:    | 8   |
| Interconnected Family Tents: | N/A   |
| Children:                    | Children of all ages welcome (triples are not offered)                              |
| Check In:                    | 12pm (no early check-ins available)   |
| Check Out:                   | 10am (no late departures available)   |
| Security:                    | 24 hour (as the camp is unfenced guests please not to walk unattended after sunset) |
| Electricity:                 | 24V DC  |
| Plug Points:                 | One regular 220V plug point in each tent and in the communal tent                   |
| Mobile Network:              | Limited mobile reception  |
| WIFI:                        | Yes   |
| Outdoor Dining:              | Yes   |
| Credit Cards:                | Yes   |
| Fitness Centre:              | Available at Angama Mara when Angama Safari Camp is located in the Mara Triangle    |
| Swimming Pool:               |   |
| Safari Shop:                 |   |
| Photographic Studio:         |   |
| Shamba Lunch:                |   |

## GUEST TENT INFORMATION

|                     |  |
|---------------------|--|
| Bed Size:           | Super king extra length (double or twin) |
| Fans:               | Standing                                 |
| Airconditioning:    | No                                       |
| Mosquito Nets:      | Yes, on request                          |
| Bath:               | No                                       |
| Shower:             | Twin Bucket Shower                       |
| Single Vanity:      | Yes                                      |
| Separate W/C:       | Yes                                      |
| Safe:               | No                                       |
| Telephone:          | No                                       |
| Emergency Siren:    | Yes                                      |
| Hairdryer:          | No (due to power restrictions)           |
| Laundry:            | Yes (24 hour turnaround)                 |
| Binoculars:         | Yes                                      |
| Size of Guest Tent: | 32 sqm (350sqft)                         |

## ACTIVITIES

|                    |  |
|--------------------|--|
| Vehicle:           | 1 vehicle for up to 6 guests; 2 for more than 6 guests |
| Morning Safaris:   | Yes  |
| Afternoon Safaris: | Yes  |
| All-Day Safaris:   | Yes  |
| Night Safaris:     | Safaris return to camp by 19h30                        |
| Walking Safaris:   | Dependant on location of the Camp                      |

|                            |   |
|----------------------------|---|
| <b>Community Visit:</b>    | Yes, available on request at an additional charge |
| <b>Hot Air Ballooning:</b> | Yes, available on request at an additional charge |
| <b>In-Tent Massage:</b>    | Yes, booked minimum of 24 hours in advance        |

## TRAVEL INFORMATION

|  |   |
|--|---|
| <b>Climate:</b>                          | Warm and temperate all year round   |
| <b>Altitude:</b>                         | 1540m (5052ft)  |
| <b>Seasons &amp; Temperatures:</b>       |   |
| <b>Summer:</b>                           | October to April  |
|  | Temperatures: min 20°C/68°F; max 34°C/94°F  |
| <b>Winter:</b>                           | May to September  |
|  | Temperatures: min 11°C/52°F; max 25°C/77°F  |
| <b>Rainy season:</b>                     | Rainfall generally occurs in brief afternoon thunder showers  |
|  | March to May  |
|  | November to mid-December  |
| <b>Malaria Protection:</b>               | Low risk – seek medical advice prior to travel  |
| <b>Currency:</b>                         | USD, GBP, EUR & Kenyan Shillings  |
| <b>Passport &amp; Visa Requirements:</b> | Many nationalities, including the US & UK, require a visa to enter Kenya. Cost is \$51 and are obtainable through an online portal. Please make sure your passport is valid for a minimum of 6 months after arrival in Kenya, with a minimum of three consecutive blank pages |

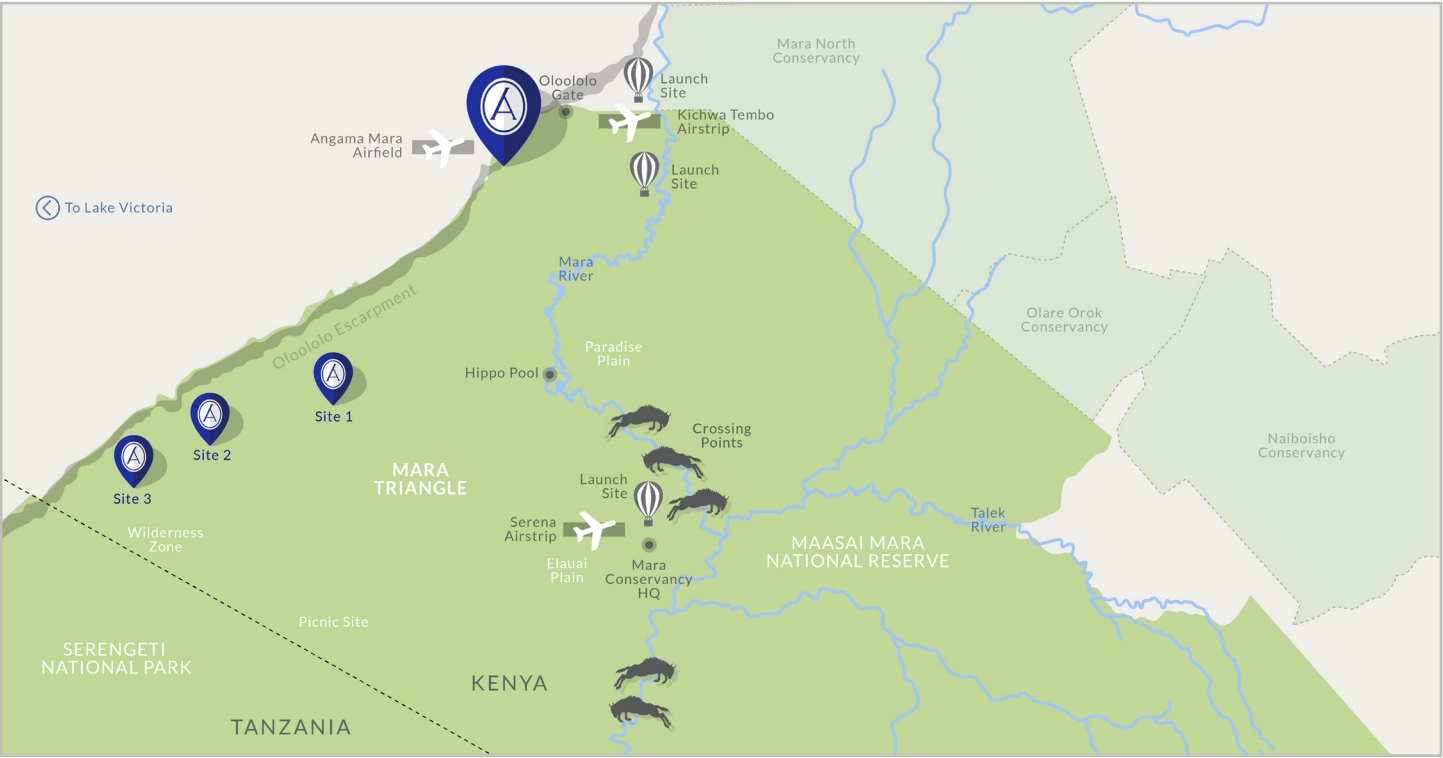

CONTACT

|                 |  |
|-----------------|--|
| Reservations    | <a href="mailto:enquiry@angama.com">enquiry@angama.com</a> |
| Travel Partners | <a href="mailto:rates@angama.com">rates@angama.com</a>     |



ANGAMA.COM