

ANGAMA MARA



Fact Sheet

"While nothing can quite prepare oneself for the first time one sees that view, the Angama Mara team are joyful in being of service, with a spirit of generosity to ensure that guests feel cared for."

Steve Mitchell, CEO & Co-Founder of Angama Mara



ANGAMA.COM

ALL YOU NEED TO KNOW:

- The views stretch for miles. Perched upon an escarpment 300 metres above the plains of the Mara below, the name of the lodge was inspired by the Swahili word for 'suspended in mid-air' and no matter where in the lodge you are, you are guaranteed the best seat in the house
- Access is easy with a short 45-minute scheduled flight from Nairobi's Wilson Airport to the Mara
- The lodge is divided into two identical but completely separate camps, each with 15 tented suites
- The tented suites span over 100sqm, including the deck and feature 11m wide floor-to-ceiling glass frontage offering views from everywhere
- Many of the loveliest scenes from Out of Africa were filmed on the site of Angama Mara. As a nod to the film, the lodge offers intimate picnics for two on the crest of the Out of Africa kopje featured on the movie's poster completed with champagne on ice and elegant picnic food
- Angama Mara's Photographic Studio is a workplace of creativity where full-time specialist photographic guides are on hand to provide tutorials, editing sessions and equipment hire
- The Shamba is a one-acre kitchen garden where guests can pick their own lunch to enjoy under the towering, shady Moth trees
- From its guides through to its camp manager, the majority of Angama Mara's staff are Maasai from local communities. This means that guests can learn more about local culture from those around them, as well as from the Maasai ladies in the Beading Studio

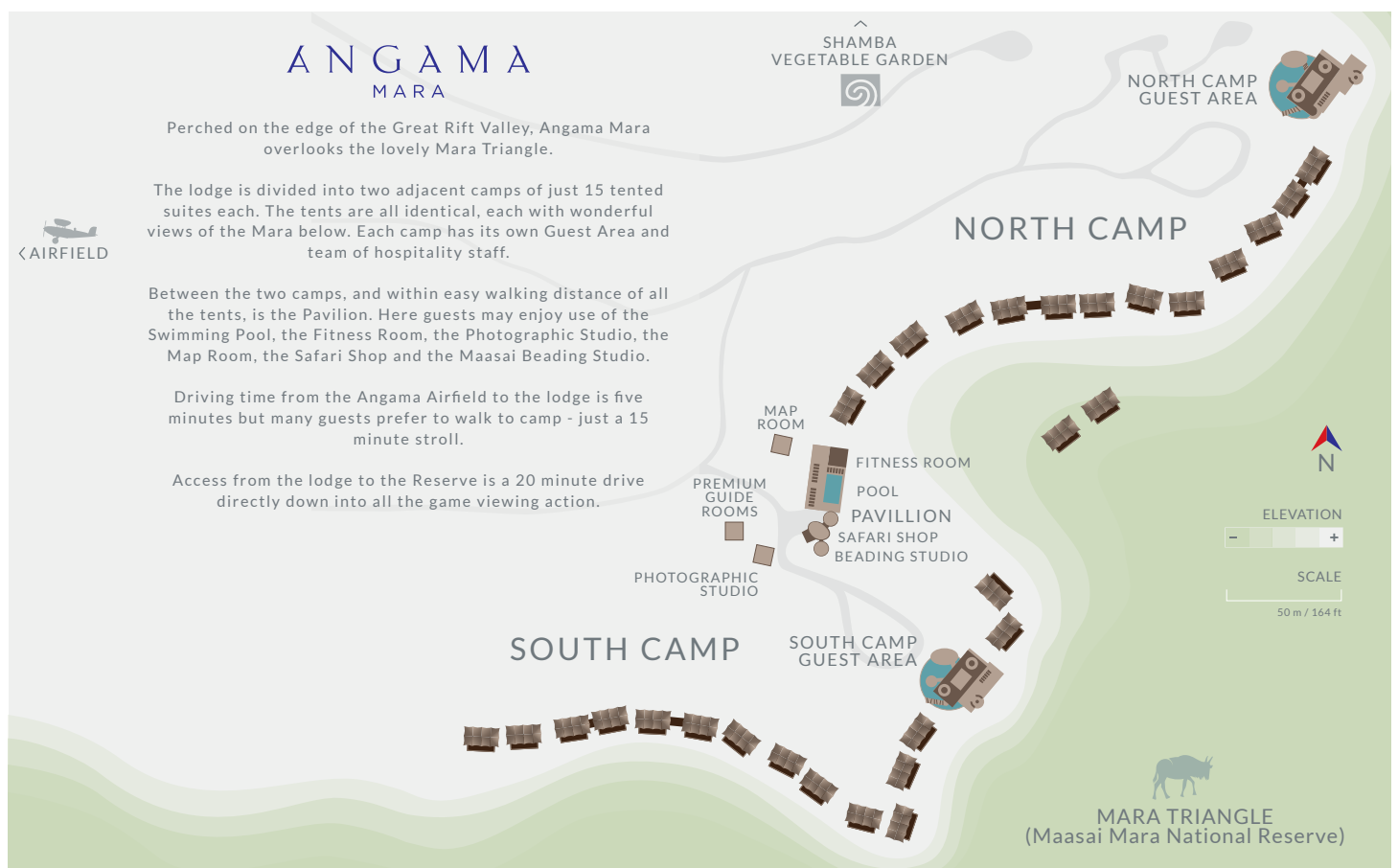

HOW TO GET HERE:

Angama Mara is easily accessed by plane from Nairobi’s Wilson Airport, with several daily flights that land in the Mara, where an Angama Mara guide will be waiting to transfer you to the lodge, which is just short game drive away.

Another popular route is to connect via the Serengeti and cross the Tanzania/Kenya border west of the Mara. From the Serengeti, it’s a short hop to Tarime, a quick road transfer across the border to the Migori airstrip in Kenya, and another short hop into the Mara.

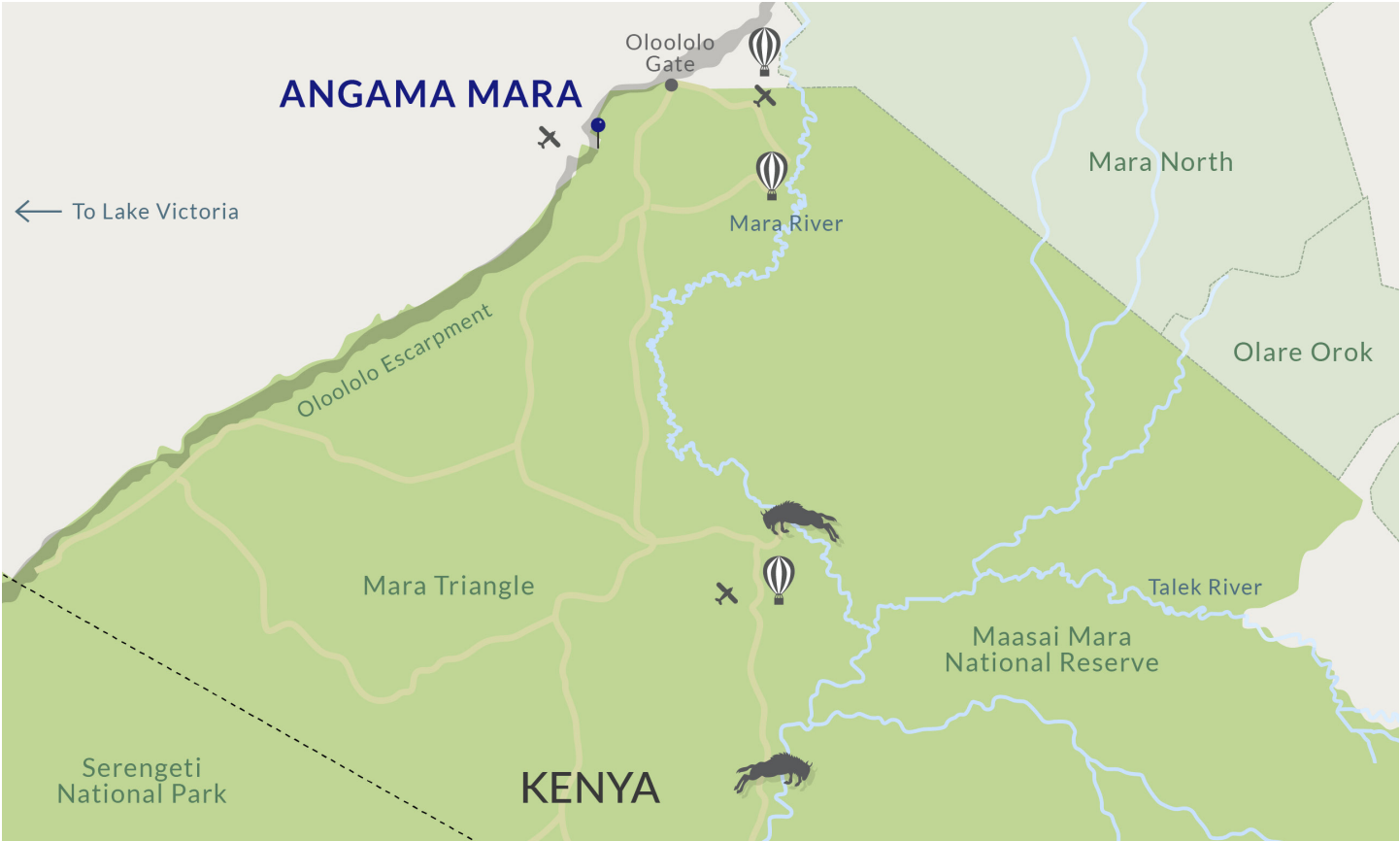

LODGE INFORMATION

Number of Guest Tents:	2 camps of 15 tented suites each
Maximum Number of Guests:	30 guests in each camp
Interconnected Family Tents:	2 sets of 2 interconnected guest suites in each camp
Children:	Children of all ages are welcome in Standard Season Children aged 6 and over are welcome during Peak Season
Childminding:	Yes – female staff

ANGAMA MARA

ANGAMA MARA TENTED SUITE

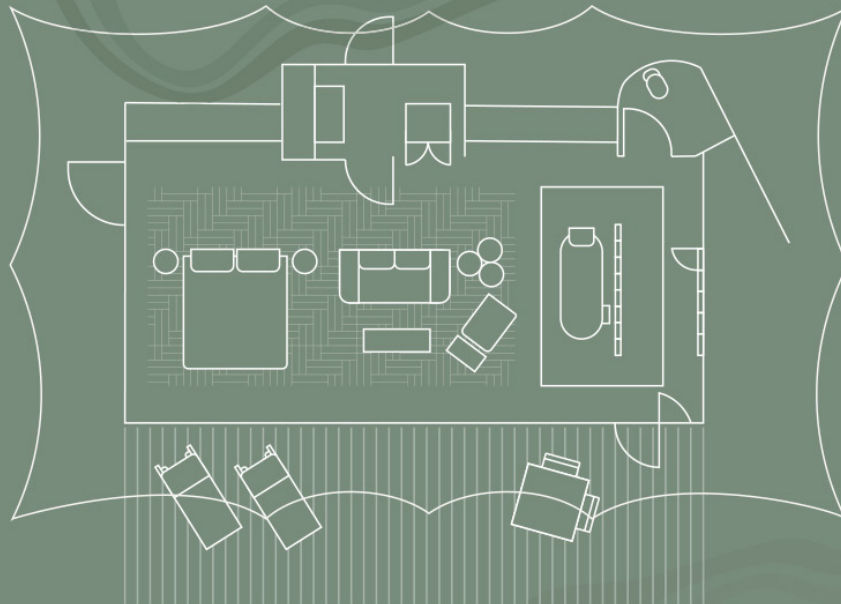

ANGAMA MARA

ANGAMA MARA INTER-CONNECTED TENT

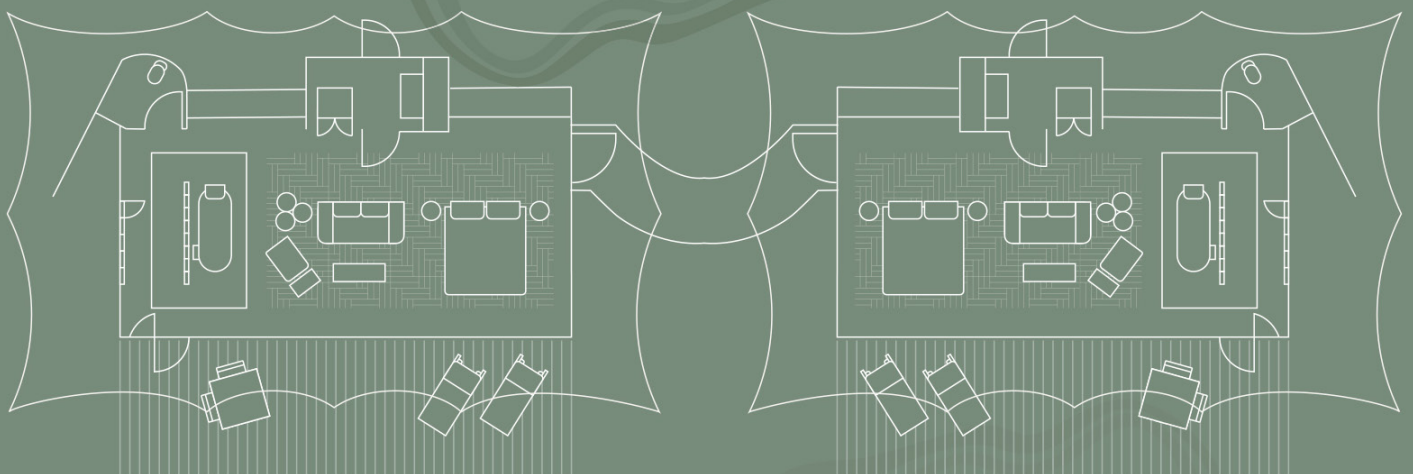

CAMP INFORMATION

Security:	24-hour The lodge is unfenced and guests are not permitted to walk unattended around the camp after sunset
Check In:	12h00
Check Out:	10h00. Change room available for guests with late departures Early check-in and late check-out subject to availability
Swimming Pool:	Available at Angama Mara
Electricity:	24V DC
Kosher Facilities:	Yes – stand-alone kitchen
Plug Points:	Yes – multiple international, 240v
Mobile Network:	Yes – several service providers
WIFI:	Yes – widespread coverage
Private Dining:	Yes
Outdoor Dining:	Yes
Credit Cards:	Yes – Visa, Mastercard and American Express
In-Room Massage:	Yes
Fitness Centre:	Yes
Library:	Yes – in each camp, equipped with TV and Africana Book and DVD collections
Safari Shop:	Yes
Photographic Equipment:	Yes – available for hire from the Photographic Studio

GUEST SUITE INFORMATION

Bed Size:	Super king extra length All suites can be configured with twin bed setup
Fans:	Yes
Airconditioning:	No
Mosquito Nets:	No – unnecessary due to sealed tents and lodge at high altitude
Bath:	Yes
Shower:	Yes
Twin Vanities:	Yes
Separate W/C:	Yes
Personal Bar:	Yes - complimentary
Safe:	Yes
Telephone:	Mobile phone and intercom
Emergency Siren:	Yes
Hairdryer:	Yes
Disabled Access:	Yes – one tented suite fully wheelchair enabled
Laundry:	Yes - complimentary
Binoculars:	Yes
Butler's Lobby:	Yes
In-Room Tea and Coffee:	Yes
Size of Guest Suite:	70 sqm (750sqft)
Size of Deck:	35 sqm (375sqft)

ACTIVITIES

Private Vehicle:	Yes – available on request at an additional charge
Morning Safaris:	Yes
Afternoon Safaris:	Yes
All-day Safaris:	Yes
Night Safaris:	Yes - limited
Walking Safaris:	Yes – on the escarpment
Community Visit:	Yes, available on request at an additional charge
Hot Air Ballooning:	Yes, available on request at an additional charge

TRAVEL INFORMATION

Climate:	Warm and temperate all year round
Altitude:	1,700m (5,580ft) above sea level
Rainfall:	Long rains: March – May Short rains: November – December Please note: rain generally occurs in brief afternoon thunder showers
Temperature:	Summer temperatures: min 20°C/68°F and max 34°C/94°F Summer: October – April Winter temperatures: min 11°C/52°F and max 25°C/77°F Winter: May - September
GPS Co-Ordinates:	1°16' 33.38" S, 34° 58' 9.34 E
Malaria Protection:	Low risk – seek medical advice prior to travel
Yellow Fever:	Many countries require travellers to have a Yellow Fever certificate prior to returning from a visit to Kenya
Currency:	USD, GBP, EUR & Kenyan Shillings
Passport & Visa Requirements:	Many nationalities, including the US and the UK, require a visa to enter Kenya. These cost US\$51 and are obtainable through an online portal. Please make sure your passport is valid for a minimum of six months after arrival in Kenya, with a minimum of three consecutive blank pages

CONTACT

Reservations	enquiry@angama.com
Travel Partners	rates@angama.com

